

Installing a Washing Machine

Remove all the packing materials prior to use

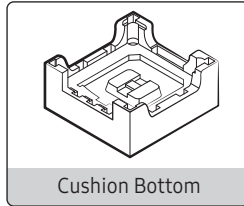

⚠ Caution

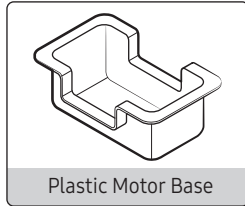
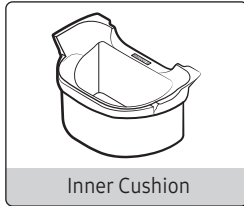
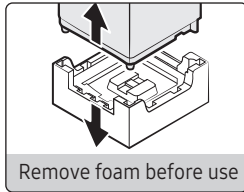

Use the machine without removing the foam bottom or the motor base (some models) causes the machine to malfunction and damage the internal components.

Drain Hose Connection

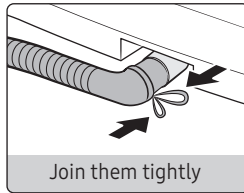
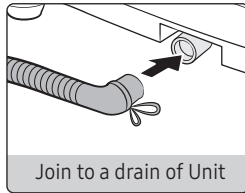
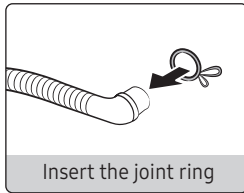

⚠ Caution

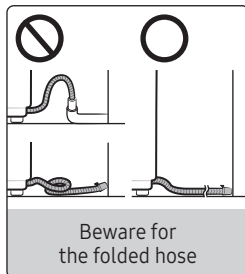
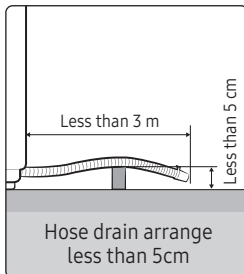

Water Supply Hose Connection

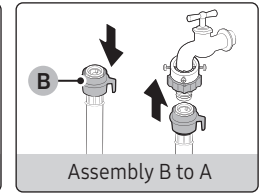
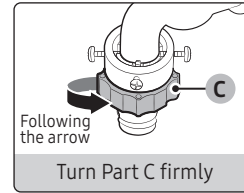
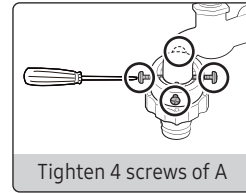
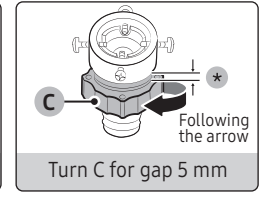
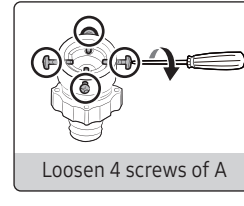
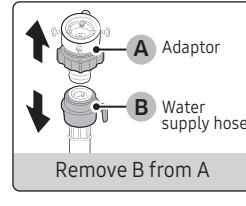

Leveling the Unit & Adjusting for Vibration

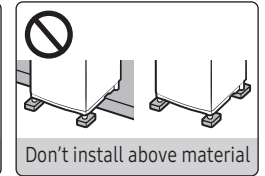
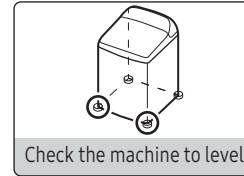
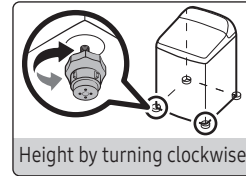
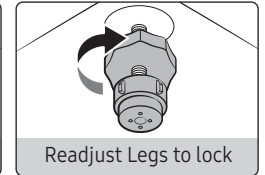
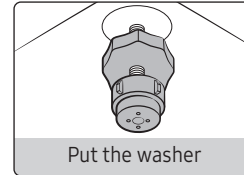
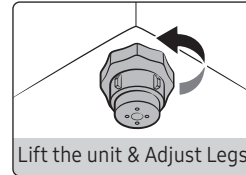

Anti-rat panel (applicable models only)

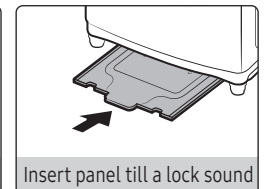
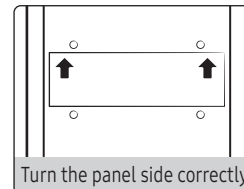
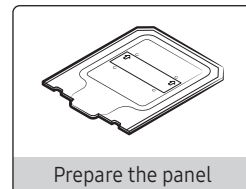

Operation and maintenance

SAMSUNG

Caring for clothes before washing

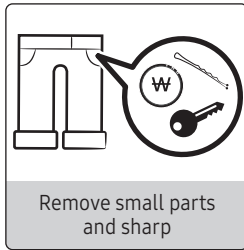

Remove small parts and sharp

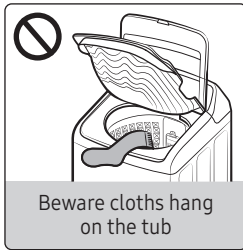

Beware cloths hang on the tub

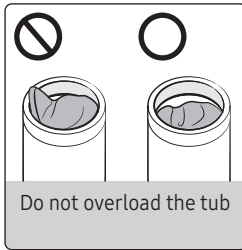

Do not overload the tub

⚠ Caution

- Metal objects such as coins, pins, and buckles on clothing may damage other laundry items as well as the tub.
- Don't overload the tub. Make sure no part of the laundry is exposed outside of the tub.
- Take a piece of cloth in the tub. To protect socks & small pieces of cloth fall into the drum space.
- To wash at large for example, a blanket may temporarily stop working between the dry button & fill the water to increase the balance.

Cleaning the filter (applicable models only)



Press down the upper area & remove

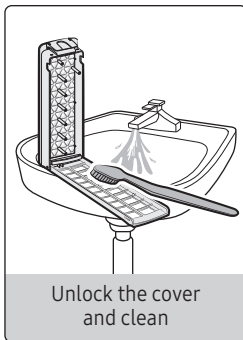

Unlock the cover and clean

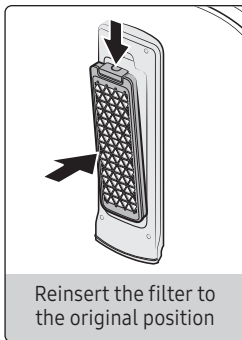

Reinsert the filter to the original position

⚠ Caution

- Regular cleaning of the filter will help to filter the debris better.
- Should be cleaned every week.

Cleaning the Mesh Filter

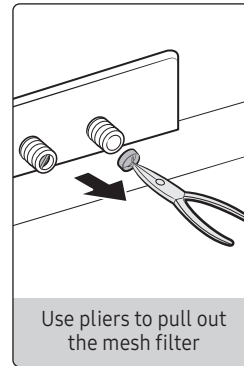

Use pliers to pull out the mesh filter

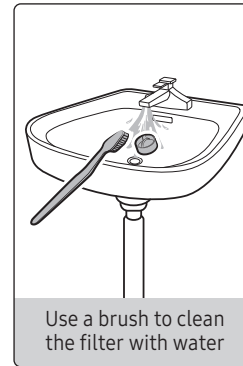

Use a brush to clean the filter with water

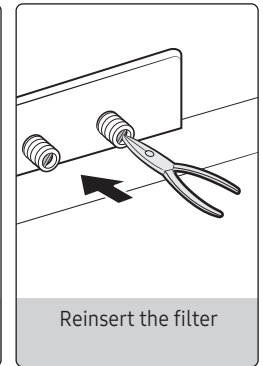

Reinsert the filter

⚠ Caution

Cleaning the mesh filter helps to improve the filtering efficiency of the water valve. (When cleaning, it should be assembled)

- Should be cleaned 3 times a month.
- Don't operate without mesh filter.

Cleaning the basket spin

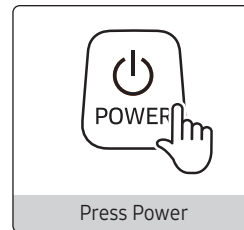

Press Power



Press Eco tub clean

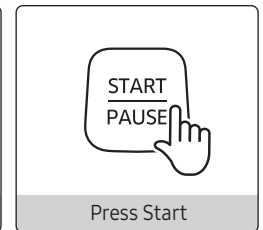

Press Start

⚠ Caution

- Eco Tub Clean must be used only when empty. If there is a fabric can damage the fabric or problems with the machine.
- When the Eco Tub Clean signal is displayed, a wash program is required. If you do not use the wash program, the alarm is still displayed for 5 cycles when to use the Eco tub clean immediately. The alarm goes away.