

TEKA

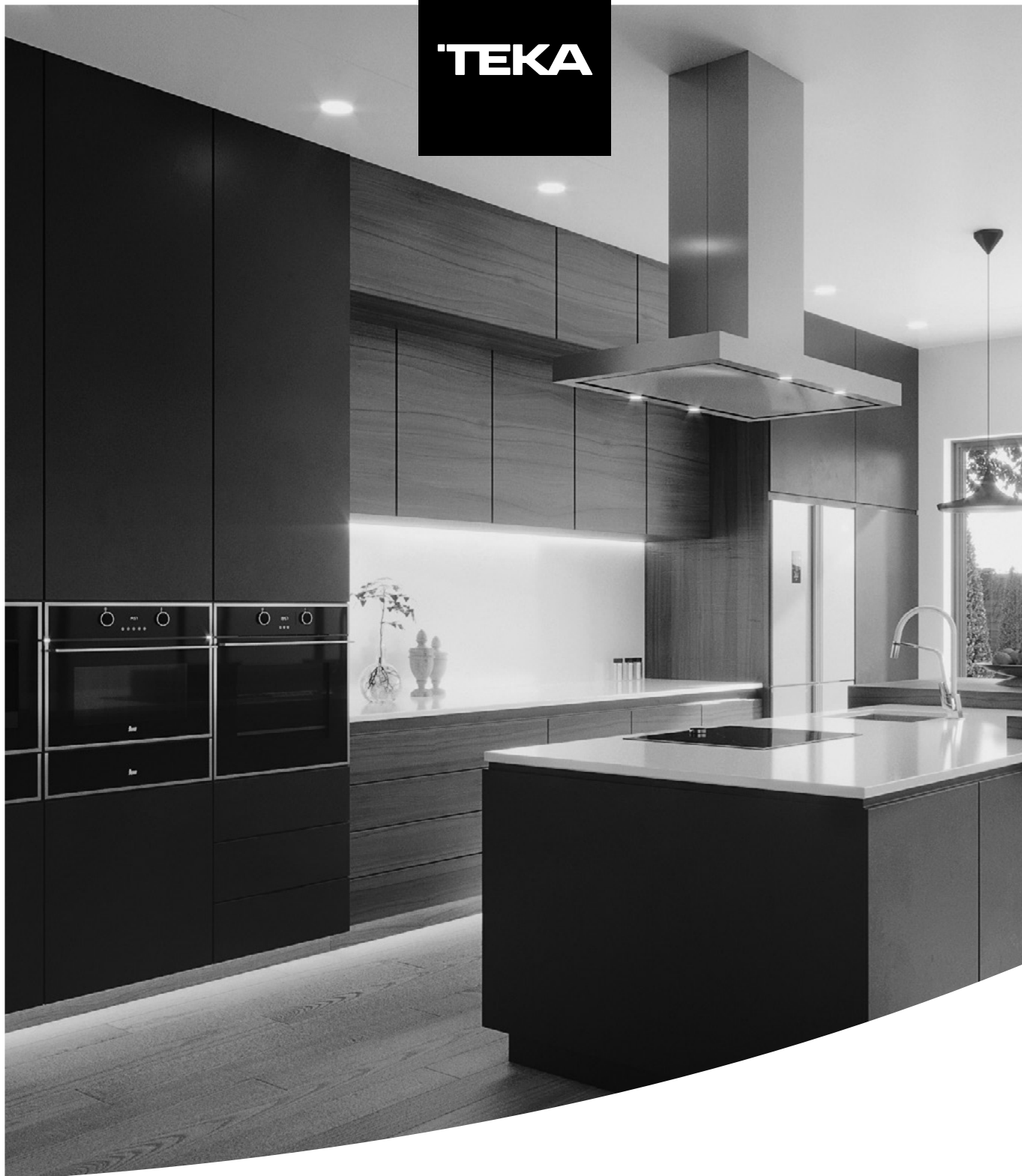

User Manual
DW9 70 FI

EN

www.teka.com



Read this Manual

Dear Customer,

- Please carefully read this manual before using the dishwasher, it will help you use and maintain the dishwasher properly.
- Keep this manual for future reference.
- Pass it on to any subsequent owner of the appliance.

This manual contains sections on safety Instructions, Operating Instructions, Installation Instructions and Troubleshooting Tips, etc.



Before Calling for Service

- Reviewing the section on troubleshooting Tips will help you solve some common problems by yourself.
- If you cannot solve the problems by yourself, please ask for help from a professional technician.



NOTE:

- The manufacturer, following a policy of constant development and updating of the product, may make modifications without giving prior notice.
- If lost or out-of-date, you can receive a new user manual from the manufacturer or responsible vendor.

| | |
|---|-----------|
| 1) Safety Instructions..... | 1 |
| 2) Quick user guide..... | 4 |
| 3) Operation Instructions..... | 5 |
| Control Panel..... | 5 |
| Dishwasher Features..... | 5 |
| 4) Prior to first time use..... | 6 |
| A、 Water Softener..... | 6 |
| B、 Loading the Salt into the Softener..... | 7 |
| C、 Filling the Rinse Aid Dispenser..... | 7 |
| D、 Function of Detergent | 8 |
| 5) preparing and loading dishes..... | 11 |
| Recommendations for loading and unloading the dishwasher..... | 11 |
| Loading the upper Basket..... | 12 |
| Loading the Lower Basket..... | 12 |
| 6) Starting a washing program..... | 13 |
| Wash Cycle Table..... | 13 |
| Turning on the Appliance..... | 13 |
| Changing the Program mid-cycle..... | 14 |
| At the end of the Wash Cycle..... | 14 |
| 7) Maintenance and cleaning..... | 15 |
| Filter System..... | 15 |
| Caring for the Dishwasher..... | 16 |
| 8) Installation instruction..... | 17 |
| Installation preparation..... | 17 |
| Aesthetic panel's dimensions and installation... .. | 18 |
| Connection of drain hoses..... | 20 |
| Dishwasher installation steps..... | 21 |
| About Electricity Connecting..... | 22 |
| Cold Water Connection..... | 23 |
| 9) Troubleshooting Tips..... | 24 |
| Before calling for service..... | 24 |
| Error codes..... | 25 |
| Technical information..... | 26 |
| Loading the baskets according to En50242 | |

1. IMPORTANT SAFETY INFORMATION

! WARNING! When using your dishwasher, follow the precautions listed below:

- This appliance is intended to be used in household and similar applications such as:
 - staff kitchen areas in shops, offices and other working environments;
 - farm houses;
 - by clients in hotels, motels and other residential type environments;
 - bed and breakfast type environments.
- This appliance can be used by children aged from 8 years and above and persons with reduced physical, sensory or mental capabilities or lack of experience and knowledge if they have been given supervision or instruction concerning use of the appliance in a safe way and understand the hazards involved. Children shall not play with the appliance. Cleaning and user maintenance shall not be made by children without supervision. (For EN60335-1)
- This appliance is not intended for use by persons (including children)with reduced physical, sensory or mental capabilities, or lack of experience and knowledge ,unless they have been given supervision or instruction concerning use of the appliance by a person responsible for their safety. (For IEC60335-1)
- This appliance is for indoor use only, for household use only.
- To protect against the risk of electrical shock, do not immerse the unit, cord or plug in water or other liquid.
- Please unplug before cleaning and maintenance the appliance .
- Use a soft cloth moisten with mild soap, and then use a dry cloth to wipe it again.



EARTHING INSTRUCTIONS

- This appliance must be earthed. In the event of a malfunction or breakdown, earthing will reduce the risk of an electric shock by providing a path of least resistance of electric current. This appliance is equipped with a cord having an equipment-earthing conductor and a grounding plug.
- The plug must be plugged into an appropriate outlet that is installed and earthed in accordance with all local codes and ordinances.
- Improper connection of the equipment-earthing conductor can result in the risk of an electric shock.
- Check with a qualified electrician or service representative if you are in doubt whether the appliance is properly grounded.
- Do not modify the plug provided with the appliance; If it does not fit the outlet.
- Have a proper outlet installed by a qualified electrician.
- Do not abuse, sit on, or stand on the door or dish rack of the dishwasher.
- Do not operate your dishwasher unless all enclosure panels are properly in place.
- Open the door very carefully if the dishwasher is operating, there is a risk of water squirting out.
- Do not place any heavy objects on or stand on the door when it is open. The appliance could tip forward.
- When loading items to be washed:
 - 1) Locate sharp items so that they are not likely to damage the door seal;

- 2) Warning: Knives and other utensils with sharp points must be loaded in the basket with their points down or placed in a horizontal position.
- Check that the detergent powder is empty after completion of the wash cycle.
- Do not wash plastic items unless they are marked dishwasher safe or the equivalent.
- For plastic items not so marked, check the manufacturer's recommendations.
- Use only detergent and rinse additives designed for an automatic dishwasher.
- Never use soap, laundry detergent, or hand washing detergent in your dishwasher.
- Children should be supervised to ensure that they do not play with the appliance.
- The door should not be left open, since this could increase the risk of tripping.
If the supply cord is damaged, it must be replaced by the manufacturer or its service agent or a similarly qualified person in order to avoid a hazard.
- During installation, the power supply must not be excessively or dangerously bent or flattened.
- Do not tamper with controls.
- The appliance is to be connected to the water mains using new hose sets and that old hose-sets should not be reused.
- The maximum number of place settings to be washed is 14.
- The maximum permissible inlet water pressure is 1MPa.
- The minimum permissible inlet water pressure is 0.04MPa.

Disposal

- This appliance's packaging materials are recyclable. Dispose of the packaging into a suitable waste collection container to recycle it.
- It is prohibited to dispose of this appliance as household waste. Correct Disposal of this product: this symbol on the product or in its packing indicates that this product may not be treated as household waste. Instead, it should be taken to the appropriate waste collection point for the recycling of electrical and electronic equipment. By ensuring this product is disposed of correctly, you will help prevent potential negative consequences for the environment and human health, which could otherwise be caused by the inappropriate waste handling of this product. For more detailed information about the recycling of this product, please contact your local council your household waste disposal service, or the shop where you purchased the product.

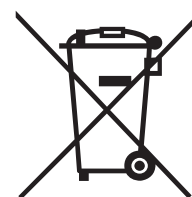

WARNING!

- For disposing of package and the appliance please go to a recycling centre. Therefore cut off the power supply cable and make the door closing device unusable.
- Cardboard packaging is manufactured from recycled paper and should be disposed in the waste paper collection for recycling.
- By ensuring this product is disposed of correctly, you will help prevent potential negative consequences for the environment and human health, which could otherwise be caused by inappropriate waste handling of this product.
- For more detailed information about recycling of this product, please contact your local city office and your household waste disposal service.
- **DISPOSAL:** Do not dispose this product as unsorted municipal waste. Collection of such waste separately for special treatment is necessary.

2.Quick user guide

For detailed operating method read the corresponding content on the instruction manual.

| | |
|---|---|
| Switch on the appliance | Open the door, touch the On/Off button to switch on the appliance . |
| Fill the detergent dispenser | Open the flap(marked with A), fill in the main wash detergent , and then close the flap; Pre wash detergent drop into the tank directly; (Follow the user instructions!) |
| Check the rinse aid level | Refill the rinse aid through the hole below the cap(marked with B) If you need . |
| Check the regeneration salt level | (On models with water softener system only.) Electric indicator on control panel (if provided). If there is no salt warning light in the control panel (for some models), you can estimate when to fill the salt into the softener by the number of cycles the dishwasher has run. |
| Load the baskets | To load the baskets, refer to the section entitled “Loading the Dishwasher Baskets” . |
| Select a programme | Touch the Programme Button until the selected programme lights up. (See the section entitled “Operation instruction”) |
| Running the dishwasher | Turn on the water tap ,close the door . The machine will start working at once. |
| <ul style="list-style-type: none"> • Changing the programme • Adding forgotten dishes in the dishwasher. • If the appliance is switched off during a wash cycle. | <ul style="list-style-type: none"> • 1. A running cycle can only be modified if it has been running for a short time. Otherwise the detergent may have already been released and the water already drained. If this is the case, the detergent dispenser must be refilled. 2. Open the door. 3. Touch the Programme Button for more than 3 seconds to cancel the running programme. 4. Select a new programme. 5. Restart the dishwasher. <ul style="list-style-type: none"> • 1. Open the door a little to stop the dishwasher. 2. After the spray arms stop working, you can open the door completely. 3. Add the forgotten dishes. 4. Close the door, the dishwasher will start running again . <ul style="list-style-type: none"> • If the appliance is switched off during a wash cycle, when switched on again, please re-select the washing cycle and operate the dishwasher according to the original Power-on state). |
| Switch off the appliance | When the working cycle has finished, the buzzer of the dishwasher will sound 8 times, then stop. Turn off the appliance using the On/Off Button. Since the appliance is standing by, it will power off automatically after 30 minutes without any operation. |
| Turn off the water tap, unload the baskets | Warning: wait a few minutes (about 15 minutes) before unloading the dishwasher to avoid handling the dishes and utensils while they are still hot and more susceptible to break. The dishes will also dry better. First start unloading the lower basketed. |

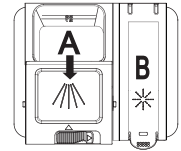

⚠ WARNING!
Open the door carefully. Look out for hot steam when opening the door!

3. Operation Instruction

! IMPORTANT To get the best performance from your dishwasher, read all operating instructions before using it for the first time.

Control Panel

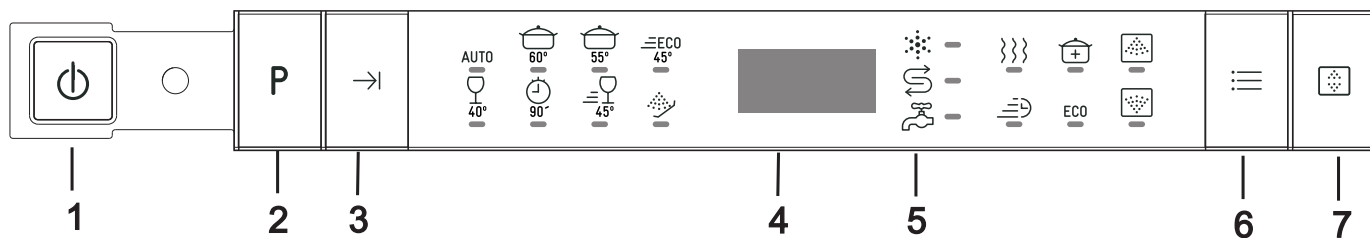

1. Power Button- touch on and off.
2. Program Buttons-touch to select the Program, corresponding indicator will be lightened;
 - Auto _____ AUTO
 - Intensive _____
 - Normal _____
 - ECO _____
 - Glass _____
 - 90Min _____
 - Rapid _____
 - Pre-wash _____
3. Delay Button;
4. Screen- Show the program time and delay time;
 - Eg: program time _____ 3:05
 - Delay time _____ H:03

5. Status Indicators :
 - Rinse detergent need to be refilled _____
 - Salt need to be refilled _____
 - Faucet is not open _____
6. Program functions, only one function can be selected in a cycle:
 - Extra Drying, improve the drying efficiency. _____
 - Power Wash, improve the cleaning efficiency. _____
 - Express, reduce the program time. _____
 - Energy Save, reduce the energy consumption. _____
7. Alt function button: Dual zone wash function, press the button to select either upper basket or lower basket loaded, and the response indicators will light on.
 - Upper basket _____
 - Lower basket _____

Dishwasher Features

Front view

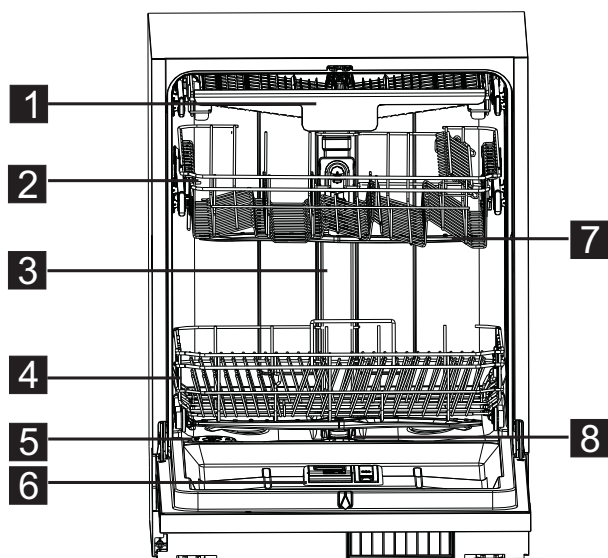

Back View

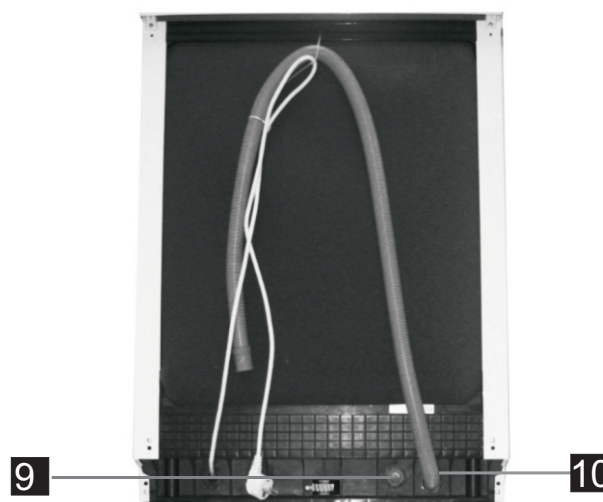

- | | | | |
|-----------------------|-------------------------|--------------------------|-------------------------------|
| 1 Cutlery rack | 4 Lower basket | 7 Spray arms | 9 Inlet pipe connector |
| 2 Upper basket | 5 Salt container | 8 Filter assembly | 10 Drain pipe |
| 3 Inner pipe | 6 Dispenser | | |

4. Prior to first time use

Before using your dishwasher for the first time:

- A. Set the water softener
- B. Add 1.5Kg dishwasher salt and then full fill the salt container with water
- C. Fill the rinse aid dispenser
- D. Fill in detergent

A. Water Softener

The water softener must be set manually, using the water hardness dial.

The water softener is designed to remove minerals and salts from the water, which would have a detrimental or adverse effect on the operation of the appliance.

The more minerals there are, the harder your water is

The softener should be adjusted according to the hardness of the water in your area. Your local Water Authority can advise you on the hardness of the water in your area.

Adjusting Salt Consumption

The dishwasher is designed to allow for adjustment in the amount of salt consumed based on the hardness of the water used. This is intended to optimise and customise the level of salt consumption.

Please follow the steps below for adjustment in salt consumption.

1. Open the door, Switch on the appliance within 60 seconds;
2. Press the Program button more than 5 seconds to enter the setup mode.
3. Press the Program button to select the proper set according to your local environment, the sets will change as the following sequence: H1->H2->H3->H4->H5->H6;
4. Press power button to exit the setup model.

| WATER HARDNESS | | | | Selector Position | Salt consumption (gram/cycle) |
|----------------|-------|---------|---------|-------------------|-------------------------------|
| °dH | °fH | °Clarke | mmol/l | | |
| 0~5 | 0~9 | 0~6 | 0~0.94 | H1 | 0 |
| 6-11 | 10-20 | 7-14 | 1.0-2.0 | H2 | 9 |
| 12-17 | 21-30 | 15-21 | 2.1-3.0 | H3 | 12 |
| 18-22 | 31-40 | 22-28 | 3.1-4.0 | H4 | 20 |
| 23-34 | 41-60 | 29-42 | 4.1-6.0 | H5 | 30 |
| 35-55 | 61-98 | 43-69 | 6.1-9.8 | H6 | 60 |

Note:1

$$1^{\circ}\text{dH}=1.25^{\circ}\text{Clarke}=1.78^{\circ}\text{fH}=0.178\text{mmol/l}$$

°dH: German degree

°fH: French degree

°Clark: British degree

Note:2

The manufactory setting: H3 (EN 50242)

Contact your local water board for information on the hardness of your water supply.

NOTE: If your model does not have any water softener, you may skip this section.

WATER SOFTENER

The hardness of the water varies from place to place. If hard water is used in the dishwasher, deposits will form on the dishes and utensils.

The appliance is equipped with a special softener that uses a salt container specifically designed to eliminate lime and minerals from the water.

B. Loading the Salt Into the Softener

Always use the salt intended for dishwasher use.

The salt container is located beneath the lower basket and should be filled as explained in the following:

Warning!

- Only use salt specifically designed for dishwashers use! Every other type of salt not specifically designed for dishwasher use, especially table salt, will damage the water softener. In case of damages caused by the use of unsuitable salt the manufacturer does not give any warranty nor is liable for any damages caused.
- Only fill with salt before running a cycle.
This will prevent any grains of salt or salty water, which may have been spilled, remaining on the bottom of the machine for any period of time, which may cause corrosion.

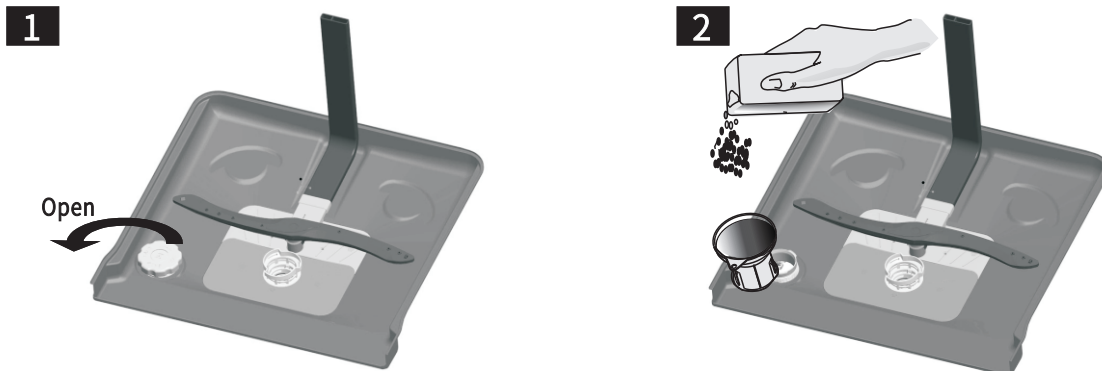

- A** After the lower basket has been removed, unscrew and remove the cap from the salt container. **1**
- B** Place the end of the funnel (supplied) into the hole and introduce about 1.5kg of dishwasher salt.
- C** Fill the salt container to its maximum limit with water, it is normal for a small amount of water to come out of the salt container. **2**
- After filling the container, screw back the cap tightly.
- E** The salt warning light will stop being on after the salt container has been filled with salt.
- F** Immediately after filling the salt into the salt container, a washing program should be started (We suggest to use a short program). Otherwise the filter system, pump or other important parts of the machine may be damaged by salty water. This is out of warranty.

! NOTE:

1. The salt container must only be refilled when the salt warning light in the control panel comes on. Depending on how well the salt dissolves, the salt warning light may still be on even though the salt container is filled.
If there is no salt warning light in the control panel (for some Models), you can estimate when to fill the salt into the softener by the cycles that the dishwasher has run.
2. If salt has spilled, run a soak or quick program to remove it.

C. Filling the Rinse Aid Dispenser

Rinse Aid Dispenser

The rinse aid is released during the final rinse to prevent water from forming droplets on your dishes, which can leave spots and streaks. It also improves drying by allowing water to roll off the dishes. Your dishwasher is designed to use liquid rinse aids. The rinse aid dispenser is located inside, on the door and next to the detergent dispenser. To fill the dispenser, open the cap and pour the rinse aid into the dispenser until the level indicator turns completely black. The volume of the rinse aid container is about 110ml.

Function of Rinse Aid

Rinse aid is automatically added during the last rinse, ensuring thorough rinsing, a spot and streak free drying.

Warning!

Only use branded rinse aid for dishwasher. Never fill the rinse aid dispenser with any other substances (e.g. Dishwasher cleaning agent, liquid detergent). This would damage the appliance.

When to Refill the Rinse Aid Dispenser

If the rinse-aid warning indicator lights up in the control panel, you should refill the rinse aid.

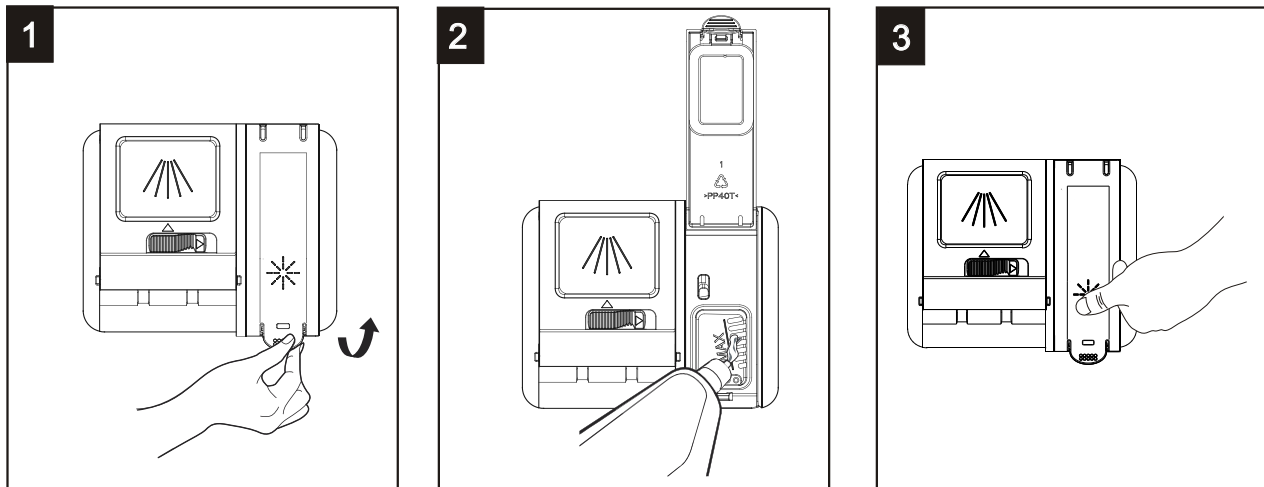

- 1 Remove the rinse reservoir cap by lifting up the handle .
- 2 Pour the rinse aid into the dispenser, being careful not to overfill.
- 3 Close the cap after all.

! **NOTE:** Clean up any rinse aid spilled while during filling with an absorbent cloth to avoid excessive foaming during the next wash. Don't forget to replace the cap before you close dishwasher door.

Adjusting Rinse Aid Dispenser

To achieve a better drying performance with limited rinse aid, the dishwasher is designed to adjust the consumption by user. Follow the below steps .

1. Power on the dishwasher by plugging in;
2. Within 60 seconds after step 1, press the Program button more than 5 seconds, and then press the Delay Button to enter the set model, the rinse aid indication blinks as 1Hz frequency.
3. Press the Program button to select the proper set according to your using habits , the sets will change in the following sequence: D1->D2->D3->D4->D5->D1, Dispenser drops more rinse aid in D5 level than in another, the manufactory setting is D3.
4. Without operation in 5 seconds or press the on/off button to exit the set model, the set success.

! **NOTE:** Increase the dose if there are drops of water or lime spots on the dishes after washing. Reduce it if there are sticky whitish stains on your dishes or a bluish film on glassware or knife blades.

D. Function of Detergent

Detergents with its chemical ingredients are necessary to remove dirt, crush dirt and transport it out of the dishwasher. Most of the commercial quality detergents are suitable for this purpose.

Attention!

Proper Use of Detergent

Use only detergent specifically made for the use in dishwashers. Keep your detergent fresh and dry. Don't put powdered detergent into the dispenser until you're ready to wash dishes.

Detergents

There are 3 sorts of detergents

1. With phosphate and with chlorine
2. With phosphate and without chlorine
3. Without phosphate and without chlorine

Normally new pulverised detergent is without phosphate. Thus the water softener function of phosphate is not given. In this case we recommend to fill salt in the salt container even when the hardness of water is only 6 °dH. If detergents without phosphate are used in the case of hard water often white spots appear on dishes and glasses. In this case please add more detergent to reach better results. Detergents without chlorine do only bleach a little. Strong and coloured spots will not be removed completely. In this case please choose a program with a higher temperature.

Concentrated Detergent

Based on their chemical composition, detergents can be split in two basic types:

- conventional, alkaline detergents with caustic components
- low alkaline concentrated detergents with natural enzymes

Detergent Tablets

Detergent tablets of different brands dissolve at different speeds. For this reason some detergent tablets cannot dissolve and develop their full cleaning power during short programs. Therefore please use long programs when using detergent tablets, to ensure the complete removal of detergent residuals.

Detergent Dispenser

The dispenser must be refilled before the start of each wash cycle following the instructions provided in the wash cycle table. Your dishwasher uses less detergent and rinse aid than Conventional dishwasher. Generally, only one tablespoon of detergent is needed for a normal wash load. More heavily soiled items need more detergent. Always add the detergent just before starting the dishwasher, otherwise it could get damp and will not dissolve properly.

Amount of Detergent to Use

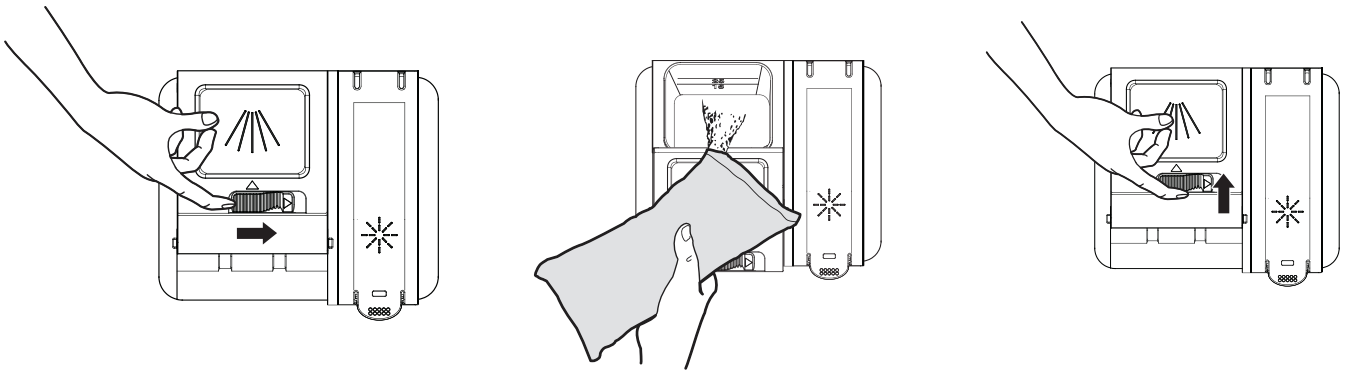

Fill in Detergent

Fill the main wash detergent in the container blew the flap;

Put the pre wash detergent into the tank directly;

! *NOTE:*

- If the lid is closed: press release button. The lid will open.
- Always add the detergent just before starting each wash cycle.
- Only use branded detergent aid for dishwasher.

! **WARNING!**

Dishwasher detergent is corrosive!

Take care to keep it out of reach of children.

! *NOTE:*

- You find information about the amount of detergent for the single programme on the last page.
- Please aware, that according to the level soiling and the specific hardness of water differences are possible.
- Please observe the manufacturer's recommendations on the detergent packaging.

5. Preparing and Loading Dishes

Recommendation

- Consider buying utensils which are identified as dishwasher-proof.
- Use a mild detergent that is described as 'kind to dishes'. If necessary, seek further information from the detergent manufacturers.
- For particular items, select a program with the lowest possible temperature.
- To prevent damage, do not take glass and cutlery out of the dishwasher immediately after the programme has ended.

For washing the following cutlery/dishes

Are not suitable

- Cutlery with wooden, horn china or mother-of-pearl handles
- Plastic items that are not heat resistant
- Older cutlery with glued parts that are not temperature resistant
- Bonded cutlery items or dishes
- Pewter or cooper items
- Crystal glass
- Steel items subject to rusting
- Wooden platters
- Items made from synthetic fibres

Are of limited suitability

- Some types of glasses can become dull after a large number of washes
- Silver and aluminum parts have a tendency to discolour during washing
- Glazed patterns may fade if machine washed frequently

Recommendations for loading and unloading the dishwasher

(For best performance of the dishwasher, follow these loading guidelines.
Features and appearance of baskets and cutlery baskets may vary from your model.)

Scrape off any large amounts of leftover food. Soften remnants of burnt food in pans.
It is not necessary to rinse the dishes under running water.

Place objects in the dishwasher in following way:

1. Items such as cups, glasses, pots/pans, etc. are faced downwards.
2. Curved items, or ones with recesses, should be loaded aslant so that water can run off.
3. All utensils are stacked securely and can not tip over.
4. All utensils are placed in the way that the spray arms can rotate freely during washing.



NOTE: Very small items should not be washed in the dishwasher as they could easily fall out of the basket.

- Load hollow items such as cups, glasses, pans etc. With the opening facing downwards so that water cannot collect in the container or a deep base.
- Dishes and items of cutlery must not lie inside one another, or cover each other.
- To avoid damage, glasses should not touch one another.
- Load large and difficult to clean items in the lower basket.
- The upper basket is designed to hold more delicate and lighter dishware such as glasses, coffee and tea cups
- Long bladed knives stored in an upright position are a potential hazard!
- Long and/or sharp items of cutlery such as carving knives must be positioned horizontally in the upper basket.
- Please do not overload your dishwasher. This is important for good results and for reasonable consumption of energy.

Removing the Dishes

To prevent water dripping from the upper basket into the lower basket, we recommend that you empty the lower basket first, followed by the upper basket.

Standard Loading Pattern

A. Loading the Upper Basket

The upper basket is designed to hold more delicate and lighter dishware such as glasses, coffee and tea cups and saucers, as well as plates, small bowls and shallow pans (as long as they are not too dirty). Position the dishes and cookware so that they will not get moved by the spray of water.

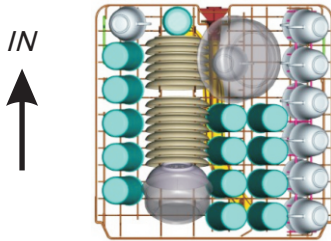

Please be reminded that:

- Pots, serving bowls, etc, must always be placed top down.
- Deep pots should be slanted to allow water to flow out.
- The Bottom Basket features folding spikes so that larger or more pots and pans can be loaded.

B. Loading the Lower Basket

We suggest that you place large items and the most difficult to clean items into the lower basket: such as pots, pans, lids, serving dishes and bowls, as shown in the figure below. It is preferable to place serving dishes and lids on the side of the racks in order to avoid blocking the rotation of the top spray arm.

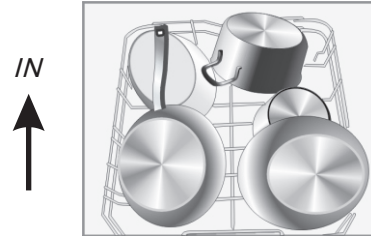

C. Adjusting the Upper Basket

The height of the upper basket can be adjusted in order to create more space for large utensils both for the upper /lower basket. The height of the upper basket can be adjusted by lift up the basket for the upper position, and up press the handle to lower the upper basket, see the picture below:

Lift the basket
for upper position

Up press the handle
to lower the basket

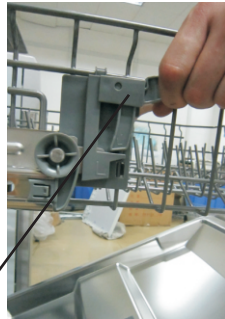

Adjust handle

D. Folding back the cup Shelves

For better stacking of cups, the shelves can be folded down as show in the picture below

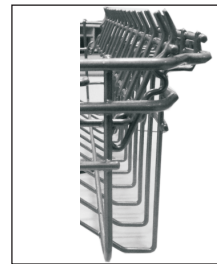
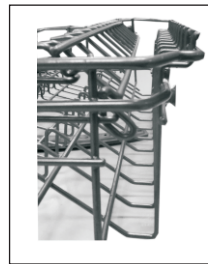

For better stacking of pots and pans, the spikes can be folded down as show in the picture below.



F. Loading the Cutlery Basket

Cutlery should be placed in the cutlery basket with the handles at the bottom. If the rack has side baskets, the spoons should be loaded separately into the appropriate slots, especially long utensils should be placed in the horizontal position at the front of the upper basket as shown in the picture.

For a top quality cleaning, place the silverware in the basket making sure that:

- They do not nest together.
- Silverware is placed with the male face up.
- Long utensils in the middle.

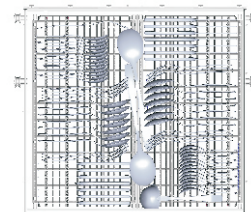







! WARNING!

- Do not let any item extend through the bottom.
- Always load sharp utensils with the sharp point down!

6. Starting a washing program

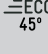
Wash Cycle Table

! **NOTE:** (★) Means: Rinse-aid dispenser needs to be filled.

| Program | Cycle Selection Information | Description of Cycle | Detergent pre/main | Running time(min) | Energy (Kwh) | Water (L) | Rinse Aid |
|--|--|--|----------------------|-------------------|--------------|-----------|-----------|
| Auto AUTO | Auto sensing wash, lightly, normally or heavily soiled crockery, with or without dried-on food | Pre-wash (45 °C) Autowash(45-55 °C) Rinse Rinse(65 °C) Drying | 5/30g 1or2 pieces | 150 | 0.9~1.3 | 11~15 | ★ |
| Intensive  | For heaviest soiled crockery, and normally soiled pots, pans, dishes etc with dried on soiling. | Pre-wash(50 °C) Wash (60 °C) Rinse Rinse Rinse(70°C) Drying | 5/30g 1or2 pieces | 175 | 1.6 | 17.5 | ★ |
| Normal  | For normally soiled loads, such as pots, plates, glasses and lightly soiled pans. | Pre-wash(45°C) Wash (55 °C) Rinse Rinse (65 °C) Drying | 5/30g 1or2 pieces | 185 | 1.3 | 13.5 | ★ |
|  (*EN 50242) | This is standard programme, it is suitable to clean normally soiled tableware and it is the most efficient programme in terms of its combined energy and water consumption for that type of tableware. | Pre-wash Wash (45 °C) Rinse(55 °C) Drying | 5/30g 1or2 pieces | 220 | 0.83 | 10 | ★ |
| Glass  | For lightly soiled crockery and glass. | Pre-wash Wash (40 °C) Rinse Rinse(60°C) Drying | 5/30g 1 piece | 130 | 0.9 | 13 | ★ |
| 90 Min  | For normally soiled loads that need quick wash. | wash(65°C) Rinse Rinse (65°C) Drying | 35g 1 piece | 90 | 1.35 | 12.5 | ★ |
| Rapid  | A shorter wash for lightly soiled loads and quick wash. | Wash (45 °C) Rinse(50 °C) Rinse (55 °C) | 25g | 30 | 0.75 | 11 | |
| Pre-wash  | To rinse dishes that you plan to wash later that day. | Prewash | | 15 | 0.02 | 4 | |

! **NOTE:**

*EN 50242 : This programme is the test cycle. The information for comparability test in accordance with EN 50242, as follows:

- Capacity: 14 settings
- Position Upper basket: upper wheels on rails
- Rinse aid setting: 6
- PI:0.49w;Po:0.45w

Turning On the Appliance

Starting a cycle wash

- 1** Draw out the lower and upper basket, load the dishes and push them back.
It is recommended to load the lower basket first, then the upper one (see the section entitled "Loading the Dishwasher").
- 2** Pour in the detergent (see the section entitled Salt, Detergent and Rinse Aid).
- 3** Insert the plug into the socket. The power supply is 220-240 VAC /50 HZ, the specification of the socket is 10A 250VAC. Make sure that the water supply is turned on to full pressure.
- 4** Open the door, touch the power button, and the On/Off light will turn on.
- 5** Touch the program Button, the wash program will be changed as following direction:

ECO→Glass→90min→Rapid→Pre-wash→Auto→Intensive→Normal→ECO;

If a program is selected, the response light will turn on. Then close the door, the dishwasher will start its cycle.

Changing the Program Mid-Cycle

Premise:

- 1 A cycle that is underway can only be modified if it has only been running for a short time. Otherwise, the detergent may have already been released, and the appliance may have already drained the wash water. If this is the case, the detergent dispenser must be refilled (see the section entitled " Loading the Detergent ").
- 2 Open the door ,touch the Program button more than 3 seconds , the machine will be in standby state, then you can change the program to the desired cycle setting (see the section entitled " Starting a wash cycle. . .").



NOTE:

If you open the door during a wash cycle , the machine will pause. The program light will stop blinking and the buzzer will mooving every minute unless you close the door . After you close the door ,the machine will keep on working again .

Forgot to Add a Dish?

A forgotten dish can be added any time before the detergent cup opens.

- 1 Open the door a little .
- 2 After the spray arms stop working, you can open the door completely.
- 3 Add forgotten dishes.
- 4 Close the door
- 5 The dishwasher will start running again.

At the End of the Wash Cycle

When the working cycle has finished, the buzzer of the dishwasher will sound for 8 seconds, then stop. Turn off the appliance using the ON/OFF button, shut off the water supply and open the door of the dishwasher. Wait for a few minutes before unloading the dishwasher to avoid handling the dishes and utensils while they are still hot and more susceptible to break. They will also dry better.

Switching Off the Dishwasher

The program light is on but is not blinking, only in this case has the program ended.

- 1.Open the door.Switch off the dishwasher by pressing the ON/OFF button.
- 2.Turn off the water tap!

Open the door carefully.

Hot dishes are sensitive to shocks. The dishes should cool down for around 15 minutes before removing from the appliance.

Open the dishwasher's door, leave it ajar and wait a few minutes before removing the dishes. In this way they will be cooler and the drying will be improved.

Unloading the dishwasher

It is normal for the dishwasher to be wet inside.

Empty the lower basket first and then the upper one. This will avoid water dripping from the upper Basket onto the dishes in the lower one.

Function Floor Light

a) Floor light will be activated constantly when the appliance is running a program. On the other hand, lights will be turned off when the door of appliance is opened.

b) Floor light will be flashing for in sequence of 1 second when a washing program is ended and the floor light will be turned off automatically after 5mins of flashing. Also if there are any buttons being pressed or door being opened, the floor light will be turned off imediately instead of flashing 5 mins.



WARNING!

It is dangerous to open the door mid-cycle, as hot steam may scald you.

7. Maintenance and Cleaning

Filter System

The filter prevents larger remnants of food or other objects from getting inside the pump. The residues may block the filter, in this case they must be removed.

The filter system consists of a coarse filter, a flat (Main filter) and a microfilter (Fine filter).

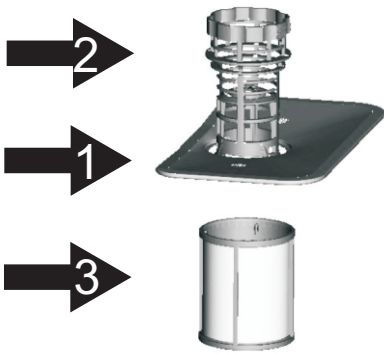

Main filter **1**

Food and soil particles trapped in this filter are pulverized by a special jet on the lower spray arm and washed down drain.

Coarse filter **2**

Larger items, such as pieces of bones or glass, that could block the drain are trapped in the coarse filter. To remove the items caught by the filter, gently squeeze the tap on the top of this filter and lift out.

Fine filter **3**

This filter holds soil and food residues in the sump area and prevents them from being redeposited on the dishes during wash cycle.

Filter assembly

The filter efficiently removes food particles from the wash water, allowing it to be recycled during the cycle. For best performance and results, the filter must be cleaned regularly. For this reason, it is a good idea to remove the larger food particles trapped in the filter after each wash cycle by rinsing the semicircular filter and cup under running water. To remove the filter device, pull the cup handle in the upward direction.

⚠ WARNING!

The dishwasher must never be used without the filters. Improper replacement of the filter may reduce the performance level of the appliance and damage dishes and utensils.



Step 1: Turn the filter counterclockwise,

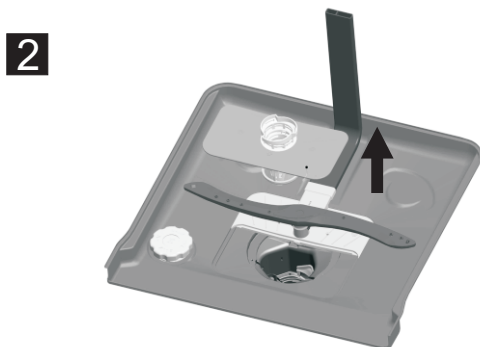

Step 2: lift the filter assembly up



NOTE: *When following this procedure from step 1 to step 2, the filter system will be removed; when following it from Step 2 to Step 1, the filter system will be installed.*

Remarks:

- After each cycle, check for any debris in the filter to avoid future blockage.
- By unscrewing the coarse filter, you can remove the filter system. Remove any food remnants and clean the filters under running water.

! NOTE: The entire filter assembly should be cleaned once a week.

Cleaning the Filter

To clean the coarse filter and the fine filter, use a cleaning brush. Reassemble the filter parts (see page 15) and reinsert them in the dishwasher, positioning them in their seat and pressing downwards.

! WARNING! When cleaning the filters, do not knock them. Otherwise, the filters could be contorted and the performance of the dishwasher could be decreased.

Caring for the Dishwasher

The control panel can be cleaned by using a lightly dampened cloth. After cleaning, make sure to dry it thoroughly.

For the exterior, use a good appliance polish wax.

Never use sharp objects, scouring pads or harsh cleaners on any part of the dishwasher.

Cleaning the Door

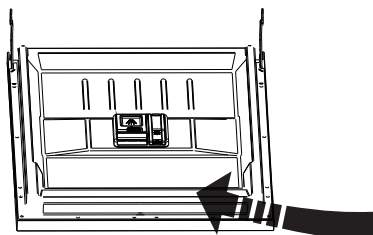

To clean the edge around the door, you should use only a soft warm, damp cloth. To avoid penetration of water into the door lock and electrical components, do not use a spray cleaner of any kind.

! WARNING!

Never use a spray cleaner to clean the door panel as it may damage the door lock and electrical components. Abrasive agents or some paper towels should not be used because of the risk of scratching or leaving spots on the stainless steel surface.

Winterizing

please take frost protection measures on the dishwasher in winter. Every time after washing cycles, please operate as follows:

1. Cut off the electrical power to the dishwasher at the supply source.
2. Turn off the water supply and disconnect the water inlet pipe from the water valve.
3. Drain the water from the inlet pipe and water valve. (Use a pan to gather the water)
4. Reconnect the water inlet pipe to the water valve.
5. Remove the filter at the bottom of the tub and use a sponge to soak up water in the sump.

! NOTE: If your dishwasher cannot work because of the ice, please contact professional service persons.

Cleaning the Spray Arms

It is necessary to clean the spray arms regularly for hard water chemicals will clog the spray arm jets and bearings.

To remove the upper spray arm, hold the nut, rotate the arm clockwise to remove it.

To remove the lower spray arm, pull out the spray arm upward.

Wash the arms in soapy and warm water and use a soft brush to clean the jets. Replace them after rinsing them thoroughly.

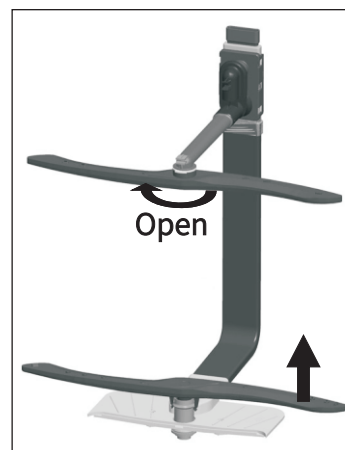

Loading the baskets according to En50242:

1. Upper basket:

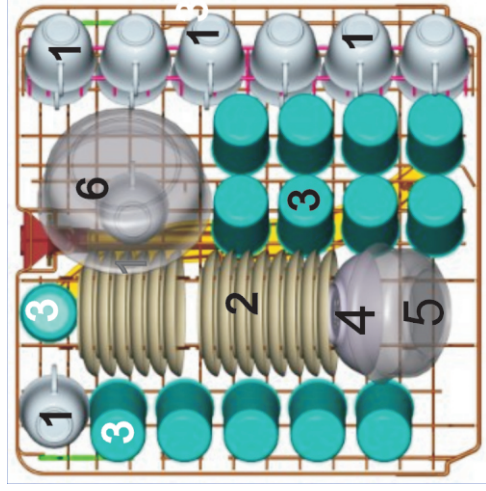

Cups



Saucers



Glasses



Small serving bowl



Medium serving bowl



Large serving bowl



Dinner plates



Dinner plates



Soup plates

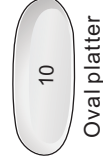

Oval platter

2. Lower basket:



3. Cutlery basket:

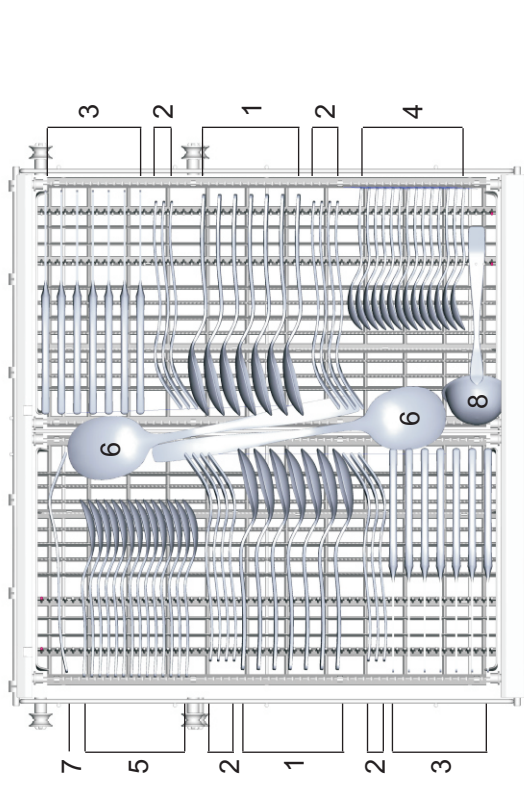

1 Soup spoons



5 Dessert spoons



2 Forks



6 Serving spoons

3 Knives



7 Serving forks

4 Teaspoons



8 Gravy ladles

Information for comparability tests in accordance with EN 50242

Capacity: 14 place settings

Position of the upper basket: lower position

Programme: ECO

Rinse aid setting: 6

Softener setting: H3

Cutlery basket could be have 5 positions:

Mode 1

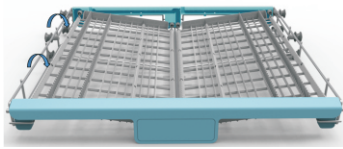

Position one: lift the left basket up, both left and right baskets are sideling.

Mode 2

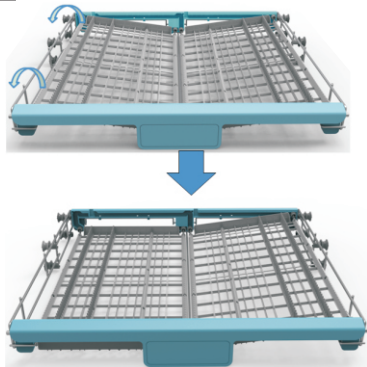

Position two: adjust the left basket to lower position, left basket is flat and right basket is sideling.

Mode 3

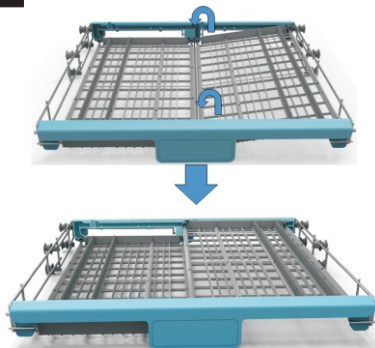

Position three: lift the right basket up, both left and right baskets are flat.

Mode 4

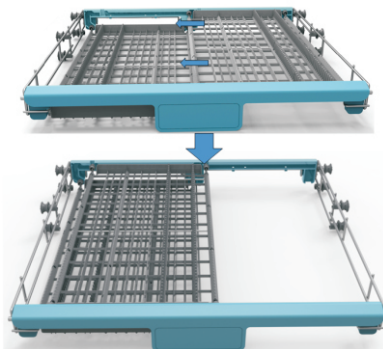

Position Four: Move the right basket from right to left, two basket are overlapping.

Mode 5

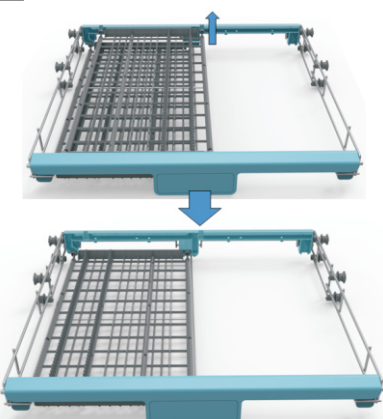

Position Five: Remove the right basket from the tray, only has the left basket.

Technical Data Sheet

Sheet of household dishwasher according to EU Directive 1059/2010:

| | |
|---|-------------------------|
| Manufacturer | TEKA |
| Type / Description | DW9 70 FI |
| Standard place settings | 14 |
| Energy efficiency class ① | A+++ |
| Annual energy consumption ② | 237 kWh |
| Energy consumption of the standard cleaning cycle | 0.83 kWh |
| Power consumption of off-mode | 0.45 W |
| Power consumption of left-on mode | 0.49 W |
| Annual water consumption ③ | 2800 litre |
| Drying efficiency class ④ | A |
| Standard cleaning cycle ⑤ | ECO 45°C |
| Program duration of the standard cleaning cycle | 220 min |
| Noise level | 44dB(A) re 1 pW |
| Mounting | build under |
| Could be build-in | Yes |
| Height | 81.5 cm |
| Width | 59.8 cm |
| Depth (with connectors) | 55.0 cm |
| Power consumption | 1760-2100 W |
| Rated voltage / frequency | 220-240 V~50 Hz |
| Water pressure (flow pressure) | 0.4-10 bar = 0.04-1 Mpa |

NOTE:

- ①** A + + + (highest efficiency) to D (lowest efficiency)
- ②** Energy consumption “237” kWh per year, based on 280 standard cleaning cycles using cold water fill and the consumption of the low power modes. Actual energy consumption will depend on how the appliance is used.
- ③** Water consumption “2800” litre per year, based on 280 standard cleaning cycles. Actual water consumption will depend on how the appliance is used.
- ④** A (highest efficiency) to G (lowest efficiency)
- ⑤** This program is suitable for cleaning soiled normally soiled tableware and that it is the most efficient programme in terms of its combined energy and water consumption for that type of tableware.

The device meets the European standards and the directives in the current version at delivery (If the version number is not in conformity with the latest standards, please refer to the latest version number.):

- LVD 2014/35/EU
- EMC 2014/30/EU
- ERP 2009/125/EC

The above values have been measured in accordance with standards under specified operating conditions. Results may vary greatly according to quantity and pollution of the dishes, water hardness, amount of detergent, etc.

The manual is based on the European Union's standards and rules.

Teka Subsidiaries

| Country Subsidiary | Address | City | Phone |
|--|--|--|-------------------|
| Austria Küppersbusch Austria | Eitnergasse, 13 | 1231 Wien | +43 18 668 022 |
| Belgium Küppersbusch Belgium S.P.R.L. | Doomveld Industrie, Asse 3, No. 11 - Boite 7 | 1731 Zellik | +32 24 668 740 |
| Bulgaria Teka Bulgaria EOOD | Blvd. "Tsarigradsko Shosse" 135 | 1784 Sofia | +359 29 768 330 |
| Chile Teka Chile S.A. | Avd El Retiro Parque los Maitenes, 1237. Parque Enea | Pudahuel, Santiago de Chile | + 56 24 386 000 |
| China Teka International Trading (Shanghai) Co. Ltd. | 6/F. Datong Business Center, No. 369 Fuxing Middle Rd. | 200025 Shanghai | +86 2 153 076 901 |
| Czech Republic Teka CZ S.R.O. | V Holesovickách, 593 | 182 00 Praha 8 - Liben | +420 284 691 940 |
| Denmark Juvél A/S | Københavnsvej 222 | DK-4600 Køge | +45 36 340 288 |
| Ecuador Teka Ecuador S.A. | Parque Ind. California 2, Via a Daule Km 12 | Guayaquil | +593 42 100 311 |
| Germany TDV GmbH&Co.KG | Sonnenweg 20 | 35708 Haiger | +49 27 713 950 |
| Great Britain Teka Products Ltd. | 177 Milton Park | OX14 4SE Milton, Abingdon | +44 1 235 861 916 |
| Greece Teka Hellas A.E. | Thesi Roupaki - Aspropyrgos | 193 00 Athens | +30 2 109 760 283 |
| Hungary Teka Magyarorszag Zrt. | Terv u. 92. | 9200 Mosonmagyaróvár | +36 96 574 500 |
| Indonesia PT Teka Buana | Jalan Menteng Raya, Kantor Taman A9 Unit A3 | 12950 Jakarta | +62 215 762 272 |
| Malaysia Teka Küchentechnik (Malaysia) Sdn Bhd | 10 Jalan Kartunis U1/47, Temasya Park, Off Glenmarie | 40150 Shah Alam, Selangor Darul Ehsan | +60 376 201 600 |
| Mexico Teka Mexicana S.A. de C.V. | Ferrocarril 200, Esquina Norte 29, Col. Moctezuma | 15500 Mexico D.F. | +52 5 551 330 493 |
| Morocco Teka Maroc S.A. | 73, Bd. Slimane, Dépôt 33, Route de Ain Sebaa | Casablanca | +212 22 674 462 |
| Netherlands Teka B.V. | Wijkermeerstraat, 34 | 2131 HA Hoofddorp | + 31 235 656 480 |
| Norway Intra, A.S | Storsand | 7563 Malvik | +47 73 980 100 |
| Poland Teka Polska Sp. ZO.O. | ul. 3-go Maja 8 / A2 | 05-800 Pruszków | +48 227 383 270 |
| Portugal Teka Portugal S.A. | Estrada da Mota - Apdo 533 | 3834-909 Ilhavo, Aveiro | +35 1 234 329 500 |
| Romania S.C. Teka Küchentechnik Romania S.R.L. | Sevastopol str., no 24, 5th floor, of. 15 | 010992 Bucharest Sector 1 | +40 212 334 450 |
| Россия ООО "Теха Рус" | ул.Неверовского, д.9, оф.30-31 | 121170, Россия, Москва | +7 495 64 500 64 |
| Singapore Teka Singapore PTE Ltd | Clemenceau Avenue, 83, 01-33/34 UE Square | 239920 Singapore | +65 67 342 415 |
| Spain Teka Industrial, S.A. | C/ Cajo,17 | 39011 Santander | +34 942 355 050 |
| Sweden Intra Mölntorp AB | Säbyvägen, 8 | 734 93 Kolbäck | +46 22 040 300 |
| Thailand Teka (Thailand) Co. Ltd. | 364/8 Sri-Ayuttaya Road, Phayathai, Ratchatavee | 10400 Bangkok | +66 -26 424 888 |
| Turkey Teka Teknik Mutfak Aletleri Sanayi Ve | Büyükdere Cad. 24/13 | 80290 Mecidiyeköy, Istanbul | +90 2 122 883 134 |
| Ukraine Teka Ukraine LLC | 86-e, Bozhenko Str .2nd floor,4th entrance | 03150 Kyiv | +380 444 960 680 |
| United Arab Emirates Teka Middle East Fze | Building LOB 16, Office 417 | P.O. Box 18251 Dubai | +971 48 872 912 |
| United Arab Emirates Teka Küchentechnik U.A.E LLC | Bin Khedia Centre | P.O. Box 35142 Dubai | +971 42 833 047 |
| Venezuela Teka Andina S.A. | Ctra. Petare-Santa Lucia, km 3 (El Limoncito) | 1070 Caracas | +58 2 122 912 821 |
| Vietnam TEKA Vietnam Co., Ltd. | 803 Dai Minh Convention Tower, 8th Floor | 77 Hoang Van Thai, District 7, Ho Chi Minh | +84 854 160 646 |



"for further information and updated contact addresses, please refer to the corporate website"



www.teka.com

Asped mos eriatius sit atet hicil et velit